

# salisbury VILLAGE

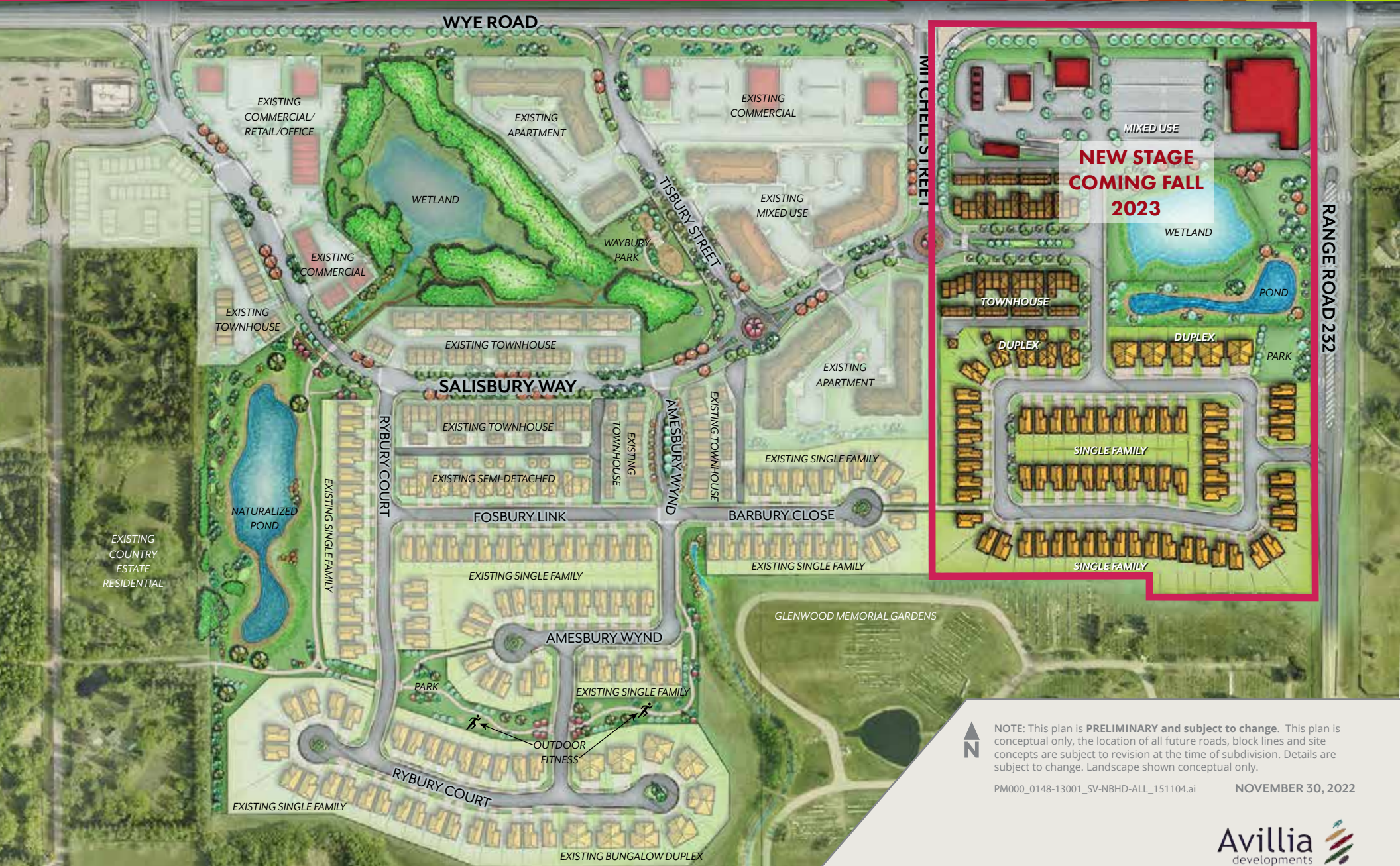

**NEW STAGE  
COMING FALL  
2023**



NOTE: This plan is **PRELIMINARY** and subject to change. This plan is conceptual only, the location of all future roads, block lines and site concepts are subject to revision at the time of subdivision. Details are subject to change. Landscape shown conceptual only.

PM000\_0148-13001\_SV-NBHD-ALL\_151104.ai

NOVEMBER 30, 2022